

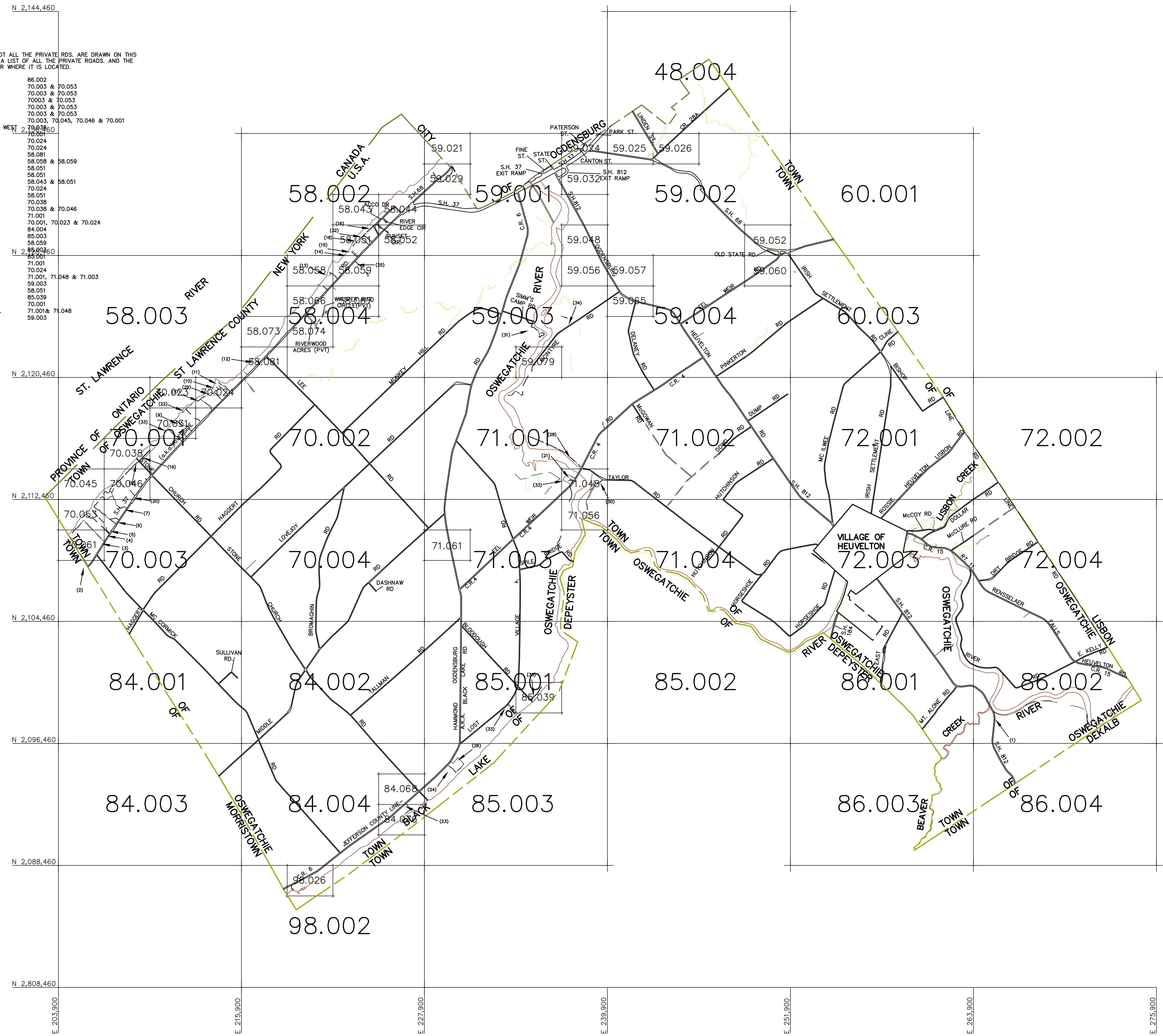

DUE TO SPACE CONSTRAINTS, NOT ALL THE PRIVATE RDS. ARE DRAWN ON THIS INDEX MAP. THE FOLLOWING IS A LIST OF ALL THE PRIVATE ROADS, AND THE CORRESPONDING SECTION NUMBER WHERE IT IS LOCATED.

- 1) BACKUS CAMP RD 86.002
- 2) BARR RD 70.003 & 70.053
- 3) CAMP RD 41 70.003 & 70.053
- 4) LIVINGSTON DRIVE 70.003 & 70.053
- 5) WELLS RD (PVT) 70.003 & 70.053
- 6) WRIGHT CAMP DR (PVT) 70.003 & 70.053
- 7) CHARBONWAY 70.003, 70.045, 70.046 & 70.001
- 8) COUNTRY CLUB SHORES RD WEST 70.038
- 9) MCGWEN LN (PVT) 70.024
- 10) LORD DR (PVT) 70.024
- 11) VIEWPOINT LANE 58.081
- 12) BASTA BLVD. 58.058 & 58.059
- 13) PECCOLO DR (PVT) 58.051
- 14) BRIGGS STREET 58.051
- 15) PEO'S LN (PVT) 58.051
- 16) KLONDIKE RD (PVT) 58.043 & 58.051
- 17) CEDAR CROFT 70.024
- 18) CEDAR SHORES 70.038 & 70.046
- 19) COUNTRY CLUB SHORES RD 70.038
- 20) DUNN POINT RD 70.038 & 70.046
- 21) EEL WEIR DR 71.001
- 22) FELL FARM RD. 70.001, 70.023 & 70.024
- 23) MEMORY LN (PVT) 84.004
- 24) CRYSTAL LN (PVT) 85.003
- 25) RUFA RD (PVT) 58.059
- 26) ROCK RD 70.001
- 27) WILSON LN (PVT) 71.001 & 71.048
- 28) LEE DR. 71.001
- 29) PERRY RD. 70.024
- 30) RIVER LN. 71.001, 71.048 & 71.003
- 31) SIMMS SHORE RD. 59.003
- 32) STONE HEDGE LN. 58.051
- 33) ZOLLAR RD. 85.009
- 34) DUBBY LN (PVT). 70.001
- 35) HOWES PINE VIEW LN (PVT). 71.001 & 71.048
- 36) SLEEPY HOLLOW LN (PVT). 59.003



NOTE: A SERIES OF SQUARE OR RECTANGULAR PARCELS (OF LESS THAN ONE ACRE) HAVING TWO OR FOUR EQUAL SIDES ARE USUALLY DIMENSIONED ON THE FIRST AND LAST LINE OF THE SERIES ONLY. ALL THE OTHER PARALLEL LINES IN THIS SERIES OF LOTS ARE TO BE CONSIDERED AS BEING THE SAME LENGTH.

APPROVED BY NEW YORK BOARD OF EQUALIZATION AND ASSESSMENT  
 CASE NO. 1549 J TAGGART (AUTHORIZED SIGNATURE)  
 JUNE 8, 1979

THIS MAP WAS PREPARED FOR TAX PURPOSES ONLY  
 NOT TO BE USED FOR CONVEYANCE

**NOTICE OF DISCLAIMER**  
 This map represents a compilation of graphical and textual information from deeds and surveys, a planimetric base map, and digital conversions of hand drawn maps. Errors and omissions can occur from each of these sources; each source represents a large number of records and originators of information. As a practical matter, the County does not warrant the accuracy or completeness of the information portrayed. The end user of these maps agrees to accept the data "as is" with the full knowledge that errors and omissions may exist, and to hold harmless the County for any damages that may result from an inappropriate use of these maps.

**DRAWING LEGEND**

International Boundary	Denotes Common Owner Railroad	Z
County Boundary	Water	
Town Boundary	Block Limit Line	
Village Boundary	Special District Line	
Property or R/W Line	Subdivision Lot Line	

Block No.	1
Parcel No.	27
Subdivision Lot No.	(10)
Deed Dimension	112'
Scaled Dimension	27'
Deed Area	(27.25)
Calculated Area	148.2A(c)

**ST. LAWRENCE COUNTY NEW YORK REAL PROPERTY**  
 COUNTY OFFICE BUILDING  
 CANTON, NEW YORK 13617  
 (315) 379-2272 OFFICE  
 (315) 229-3222 FAX

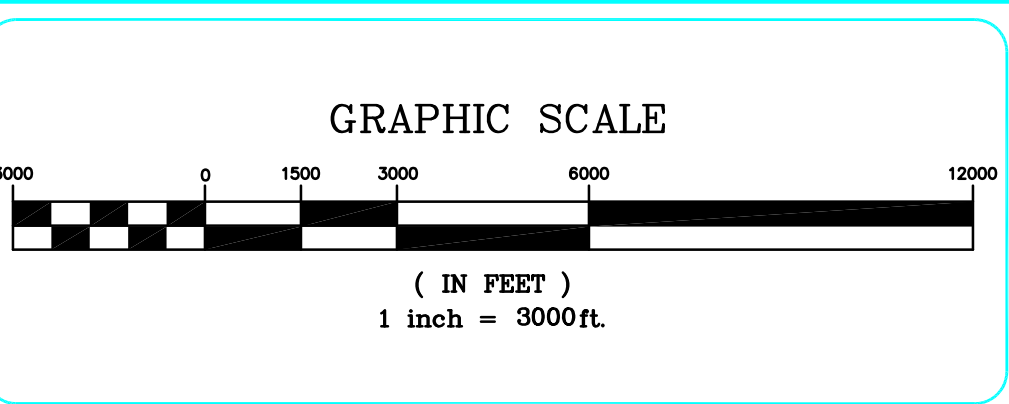

REVISIONS	DATE	BY
7		
6		
5		
4		
3		
2		
1		

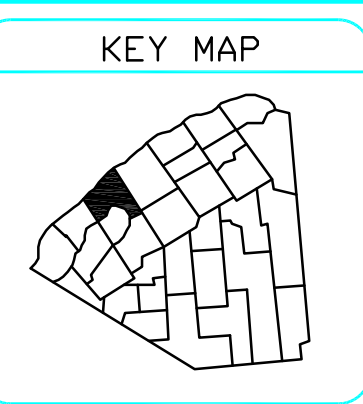

TOWN OF: **OSWEGATCHIE**  
 DISTRICT NO.: **406489**  
 Date of Conversion: 11/1/2010 LDC

SECTION NO.  
**INDEX**  
 PROPERTY MAP