

DUE TO SPACE CONSTRAINTS, NOT ALL THE PRIVATE RDS. ARE DRAWN ON THIS INDEX MAP. THE FOLLOWING IS A LIST OF ALL THE PRIVATE ROADS, AND THE CORRESPONDING SECTION NUMBER WHERE IT IS LOCATED.

- |                                |                                 |
|--------------------------------|---------------------------------|
| 1) BACKUS CAMP RD              | 86.002                          |
| 2) BARR RD                     | 70.003 & 70.053                 |
| 3) CAMP RD 41                  | 70.003 & 70.053                 |
| 4) LIVINGSTON DRIVE            | 70.003 & 70.053                 |
| 5) HELL'S RD (PVT)             | 70.003 & 70.053                 |
| 6) WRIGHT CAMP DR (PVT)        | 70.003 & 70.053                 |
| 7) CHARDONWAY                  | 70.003, 70.045, 70.046 & 70.001 |
| 8) COUNTRY CLUB SHORES RD WEST | 70.036                          |
| 9) MCEMEN LN (PVT)             | 70.024                          |
| 10) LORD DR (PVT)              | 70.024                          |
| 11) NEWPOINT LANE              | 70.024                          |
| 12) BASTA BLVD.                | 58.081                          |
| 13) PECCOLO DR (PVT)           | 58.058 & 58.059                 |
| 14) BRIGGS STREET              | 58.051                          |
| 15) PEO'S LN (PVT)             | 58.051                          |
| 16) KLONDIKE RD (PVT)          | 58.043 & 58.051                 |
| 17) CEDAR CROFT                | 70.024                          |
| 18) CEDAR SHORES               | 58.051                          |
| 19) COUNTRY CLUB SHORES RD     | 70.036                          |
| 20) BLINN POINT RD             | 70.038 & 70.046                 |
| 21) EEL WEIR DR.               | 71.001                          |
| 22) FELL FARM RD.              | 70.001, 70.023 & 70.024         |
| 23) MEMORY LN (PVT)            | 84.004                          |
| 24) CRYSTAL LN (PVT)           | 85.003                          |
| 25) RUIFA RD (PVT)             | 58.059                          |
| 26) ROCK RD                    | 85.009                          |
| 27) WILSON LN (PVT)            | 85.001                          |
| 28) LEE DR.                    | 71.001                          |
| 29) FERRY RD.                  | 70.024                          |
| 30) RIVER LN.                  | 71.001, 71.048 & 71.003         |
| 31) SIMMS SHORE RD.            | 59.003                          |
| 32) STONE HEDGE LN.            | 58.051                          |
| 33) ZOWLLAR RD.                | 85.039                          |
| 34) DUBBY LN (PVT)             | 70.001                          |
| 35) HOWES PINE VIEW LN (PVT)   | 71.001 & 71.048                 |
| 36) SLEEPY HOLLOW LN (PVT)     | 59.003                          |

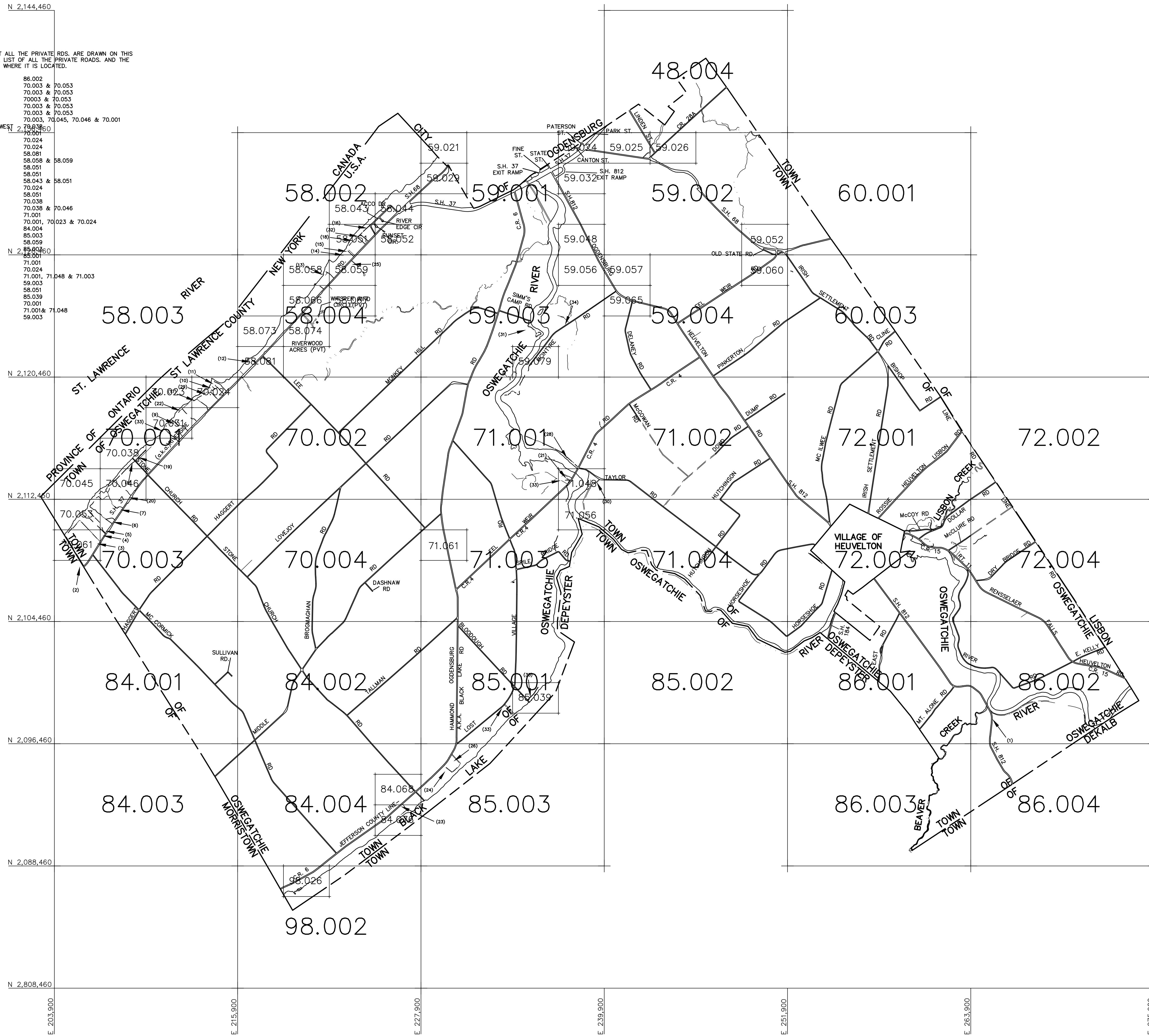

NOTE: A SERIES OF SQUARE OR RECTANGULAR PARCELS (OF LESS THAN ONE ACRE) HAVING TWO OR FOUR EQUAL SIDES ARE USUALLY DIMENSIONED ON THE FIRST AND LAST LINE OF THE SERIES ONLY. ALL THE OTHER PARALLEL LINES IN THIS SERIES OF LOTS ARE TO BE CONSIDERED AS BEING THE SAME LENGTH.

APPROVED BY NEW YORK BOARD OF EQUALIZATION AND ASSESSMENT

CASE NO. 1549 J TAGGART (AUTHORIZED SIGNATURE) JUNE 8, 1979

THIS MAP WAS PREPARED FOR TAX PURPOSES ONLY NOT TO BE USED FOR CONVEYANCE

NOTICE OF DISCLAIMER

This map represents a compilation of graphical and textual information from deeds and surveys, a planimetric base map, and digital conversions of hand drawn mylar maps. Errors and omissions can occur from each of these sources; each source represents a large number of records and originators of information. As a practical matter, the County does not warrant the accuracy or completeness of the information portrayed. The end user of these maps agrees to accept the data "as is" with the full knowledge that errors and omissions may exist, and to hold harmless the County for any damages that may result from an inappropriate use of these maps.

DRAWING LEGEND

- |                        |                       |           |
|------------------------|-----------------------|-----------|
| International Boundary | Denotes Common Owner  | Z         |
| County Boundary        | Railroad              | —+—+—+—+— |
| Town Boundary          | Block Limit Line      | —+—+—+—+— |
| Village Boundary       | Special District Line | —+—+—+—+— |
| Property or R/W Line   | Subdivision Lot Line  | —+—+—+—+— |

- |                     |           |
|---------------------|-----------|
| Block No.           | ①         |
| Parcel No.          | 27        |
| Subdivision Lot No. | (10)      |
| Deed Dimension      | 112'      |
| Scioled Dimension   | 27.8'     |
| Deed Area           | (27.3)    |
| Calculated Area     | 148.2A(c) |

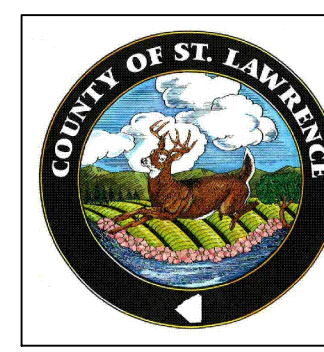

ST. LAWRENCE COUNTY  
NEW YORK  
REAL PROPERTY  
COUNTY OFFICE BUILDING  
CANTON, NEW YORK 13617  
(315) 379-2272 OFFICE  
(315) 229-3222 FAX

GRAPHIC SCALE

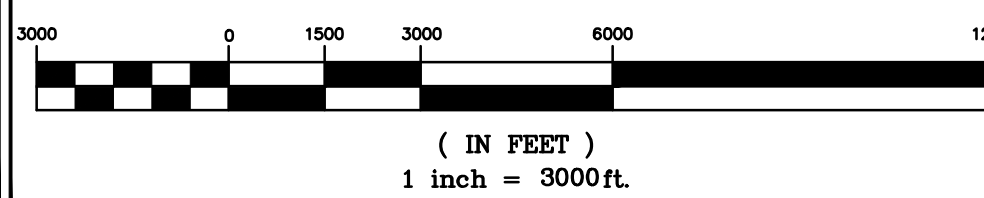

7			
6			
5			
4			
3			
2			
1			
REVISIONS		DATE	BY

KEY MAP

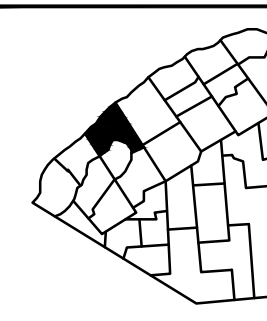

TOWN OF: OSWEGATCHIE  
DISTRICT NO.: 406489  
Date of Conversion: 11/1/2010 LDC

SECTION NO.

INDEX  
PROPERTY MAP